



# Presidential Plaza

15655 John F. Kennedy Blvd.  
Houston, Texas 77032  
N. of Beltway 8, West of US 59 North  
East of Hardy Toll Road



## For Lease

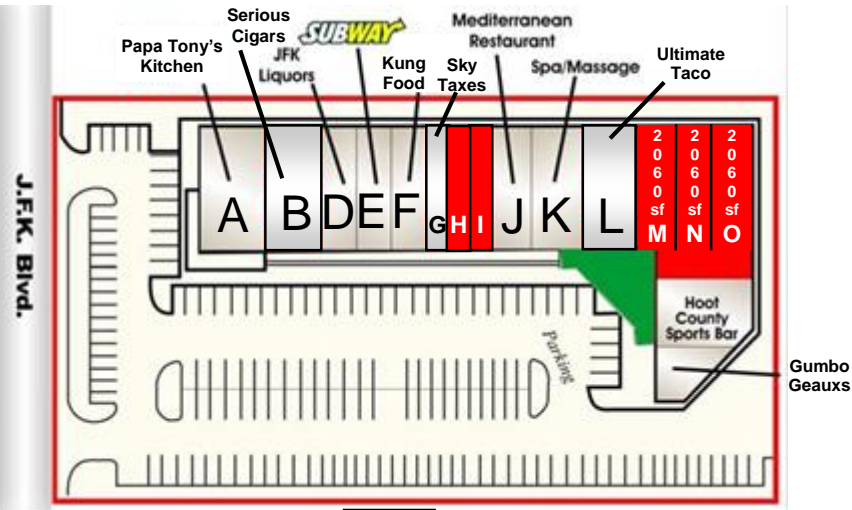

Space Available ■

Suite #	SF	Rates	Available
Suite H	1,875	\$17.50	Upon B/O
Suite I	1,125	\$17.50	Upon B/O
Suite M	2,060	\$17.50	Upon B/O
Suite N	2,060	\$17.50	Upon B/O
Suite O	2,060	\$17.50	Upon B/O

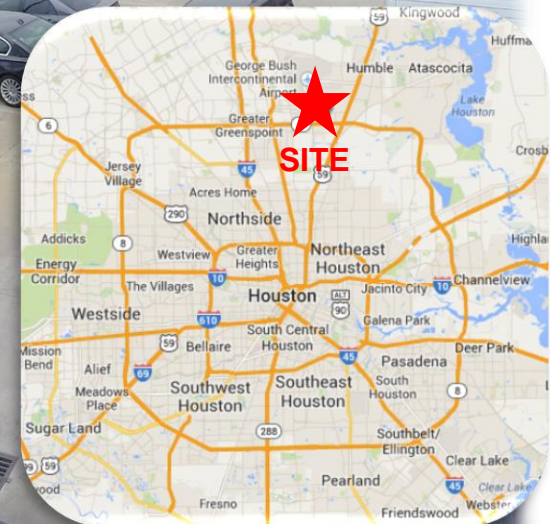

[www.presidentialplaza.info](http://www.presidentialplaza.info)

**PARKING**  
5.12 per 1000

**TENANT IMPROVEMENTS**  
Vanilla Box

**EMPLOYED WITHIN 1 MILE**  
68,000+ Direct/Indirect Airport Employees

**NNN**  
\$6.40 per square foot

**TRAFFIC COUNT**  
80,000 per day

**DUBE'S COMMERCIAL INC**

Contact: **Bob Dube** Dube's Commercial, Inc.  
[bob@dubescmercial.com](mailto:bob@dubescmercial.com) **512-671-8008**

# PRESIDENTIAL PLAZA SITE PLAN

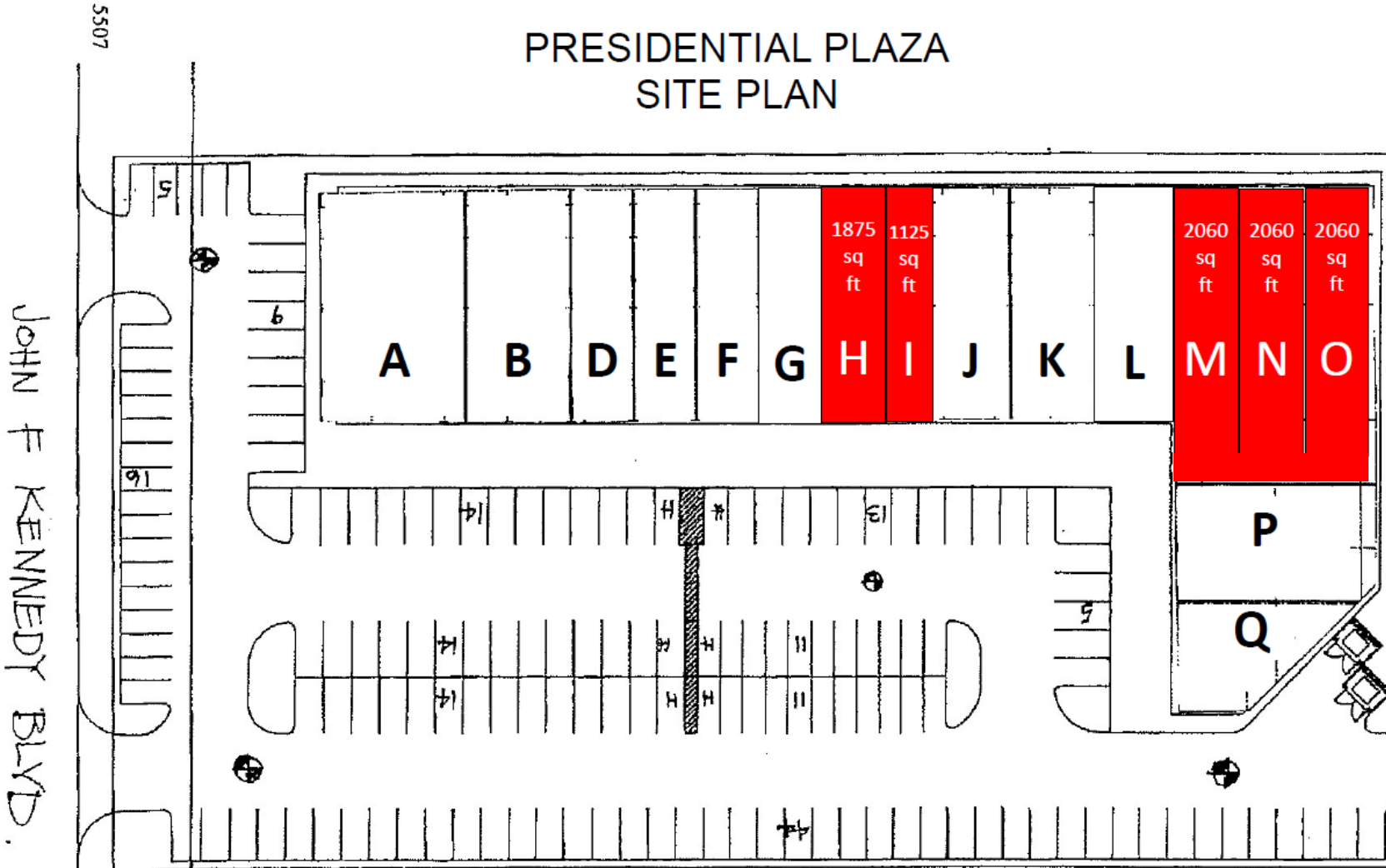

The Presidential Plaza is located in the prestigious World Houston International Business Center and is strategically situated at the main entrance of George Bush Intercontinental Airport. It enjoys easy access to major freeways leading to downtown, Galleria and NRG Stadium. Houston's Bush Intercontinental Airport, located 23 miles north of Houston, is the 8<sup>th</sup> largest airport in the world and boasts over 10,000 acres and 30,000 employees working round-the-clock shifts, 7 days a week, which is more than most towns in Texas.

The Presidential Plaza is also located adjacent to the Greenspoint Business Center, which has 17 million square feet of office, retail and industrial buildings, 8,600 hotel rooms and also has 50,000 workers and 85,000 residents.

Suite	SF	Tenant	Suite	SF	Tenant
A	3,500	Papa Tony's Kitchen	J	2,000	Mediterranean Restaurant
B	2,500	Serious Cigars	K	2,000	Spa Massage
D	1,500	JFK Liquors	L	1,800	Ultimate Taco
E	1,500	Subway	M	2,060	Vacant
F	1,500	Kung Food	N	2,060	Vacant
G	1,125	Sky Taxes	O	2,060	Vacant
H	1,875	Vacant	P	2,369	Hoot Country
I	1,125	Vacant	Q	1,500	Gumbo Geaux's
				30,474	Total SF